



Windmills • Float Valves • Cylinders • Cup Leathers
Hand Pumps • Foot Valves • Check Valves

California Windmills
PO Box 1613
Diamond Springs, CA 95619

(888) 622-8101 (530) 622-8101
diamondcraneinc@yahoo.com

PUMPING CAPACITIES CHART

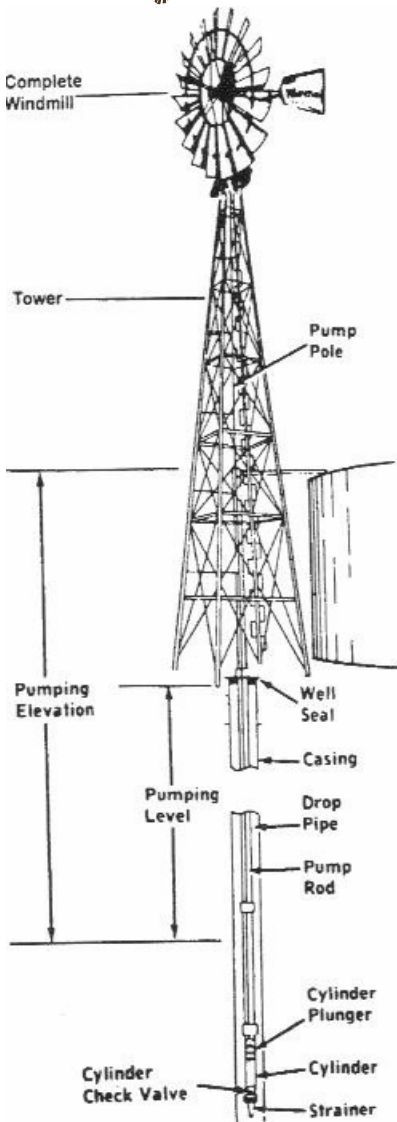

Under ordinary conditions, the actual quantity of water delivered will fall considerably below the theoretical capacity. Where the prevailing winds are light or variable, where the wind usually blows only a few hours each day, where the wind exposure is poor, or when it is desired to have the wheel run at less than its maximum speed, these conditions should be taken into consideration in determining the size of the windmill needed to supply the required quantity of water.

With the tail vane spring set for maximum tension, the 6 foot and 8 foot mills are running at full speed and will make about 32 strokes of the pump per minute; the 10 foot, 26 strokes; the 12 foot, 21 strokes; the 14 foot, 18 strokes; and the 16 foot, 16 strokes. The smaller mills will attain this speed in winds blowing steadily from 15 to 18 miles per hour, and the larger ones in winds from 18 to 20 miles per hour, when loaded according to the table.

The tension of the vane spring can be adjusted so that the maximum number of strokes will be about 2/3 of the figures given above, or any number of strokes between the two limits which may be desired.

Capacities shown in the "Pumping Capacity" table are appropriate, based on the mill set on the long stroke, operating in a 15 to 20 mile per hour wind. The short stroke increases elevation by one-third and reduces pump capacity one-fourth.

The pumping capacity of all windmills from 8 feet to 16 feet is the same with cylinders of the same diameter. This is because the length of stroke is increased in proportion to the size of the wheel. With the 6 foot mill, which is back-gearred more than the other sizes and has a stroke of only 5 1/2 inches, the quantity of water delivered is about 30% less than for the other sizes. The reduction in capacity for any particular

size of cylinder is compensated for in the ability of the 6 foot mill to raise water to a greater elevation than its true proportion. Pumps and cylinders

used with the various sizes of mills i.e.: 8 inches for 8 foot, 10 inches for 10 foot, etc.

The capacities shown in the "pumping capacity" table are based on the long stroke of the mills. When the short stroke is used, the capacity should be reduced by about 25%. However, the same quantity of water may be obtained by using a cylinder of larger diameter so as to increase its capacity 25%.

The loads recommended in the table are for moderate wind conditions. In localities where the winds are strong, these loads may be considerably increased. To obtain the best results in light winds, the table should be followed closely. A windmill should stand at least 15 feet above all obstructions within 400 feet.

Never use pipe smaller than the sizes for which our cylinders are fitted. For wells more than 100 feet deep, the best results are obtained by using Deep Well Cylinders with pipe larger than the cylinders so that the plunger can be drawn up through it.

Size of Cylinder (Inches)	Capacity per Hour (Gal.)		Elevation in Feet to Which Water Can be Raised				
			Windmill Size				
	6'	8-16'	6'	8'	10'	12'	16'
1-3/4	105	150	130	185	280	420	990
1-7/8	125	180	120	175	260	390	920
2	130	190	95	140	215	320	750
2-1/4	180	260	77	112	170	250	590
2-1/2	225	325	65	94	140	210	490
2-3/4	265	385	56	80	120	180	425
3	320	470	47	68	100	155	360
3-1/2	440	640	35	-	76	115	265
3-3/4	-	730	-	-	65	98	230
4	570	830	27	37	58	86	200

Model	Mill Size	Stroke (Inches)		No. of Sails	Back Geared	Max. Strokes Per Min.	At Wind Velocity (MPH)	Max. Wheel RPM
	Wheel Diameter	Long	Short					
X	6	5-1/4"	3-1/2"	18	3.91:1	32	15-18	125
A	8	7-1/2"	5-1/2"	18	3.29:1	32	15-18	105
B	10	9-1/2"	7"	18	3.29:1	26	15-18	85
D	12	11-1/2"	8-1/2"	18	3.50:1	21	18-20	73
F	16	14-7/8"	11-3/8"	18	3.29:1	16	18-20	53

WINDMILL PARTS



Complete Windmills

New Complete Windmills - Model 702

Part No.	Wheel Size (ft.)	Stroke (inches)	Gear Ratio	Weight (lbs.)	Code	Retail
X702CMU	6	5-1/4 or 3-1/2	3.91:1	200	C	2,400.00
A702CMU	8	7-1/2 or 5-1/2	3.29:1	350	C	2,490.00

Refurbished Windmills - Model 702

Part No.	Wheel Size (ft.)	Stroke (inches)	Gear Ratio	Weight (lbs.)	Code	Retail
X702CR	6	5-1/4 or 3-1/2	3.91:1	200	C	2,340.00
A702CR	8	7-1/2 or 5-1/2	3.29:1	350	C	2,490.00
B702CR	10	9-1/2 or 7	3.29:1	640	C	4,175.00
D702CR	12	11-1/2 or 8-1/2	3.5:1	1,100	C	6,900.00

Refurbished Windmills - Model 602

Part No.	Wheel Size (ft.)	Stroke (inches)	Gear Ratio	Weight (lbs.)	Code	Retail
X602CR	6	5-1/4 or 3-1/2	3.91:1	200	C	2,880.00
A602CR	8	7-1/2 or 5-1/2	3.29:1	350	C	2,810.00
B602CR	10	9-1/2 or 7	3.29:1	640	C	4,250.00

Items Included with Complete Windmills

Quantity	Part No.	Description
1	702	Gearbox with Galvanized Helmet
1	28	Tail Vane Spring
1	171	Pump Rod
1	510	Pivot Bolt
1	609	Lower Furl Ring with Arms
1	613	Upper Furl Ring with Arms
1	632	Brake Apparatus
1	659	Tail Buffer Device
1	661	Mast Pipe with Base
12	736	Galvanized Wheel Arms with Nuts
1	748	Complete Galvanized Tail Assembly
6	799	Galvanized Wheel Sections - Pre Assembled
1	243	Steel Furl Handle
1	62	Pump Pole/Well Rod Casting
Quart(s)	Oil	Windmill Oil

WINDMILL PARTS

Windmill Towers



Stub Tower w/ Nuts and Bolts							
Length (ft.)	Code	Windmill Size					
		6/8 FT		10 FT		12 FT	
		Retail	Weight	Retail	Weight	Retail	Weight
3	C	172.25	35	228.00	40	-	-
4	C	288.75	75	-	-	432.00	100
5	C	-	-	379.20	100	-	-
7	C	367.50	115	468.00	125	519.75	160

**3 ft stub towers do not include platform

**4 ft, 5 ft & 7 ft stub towers include applicable platforms

Standard Tower w/ Anchors, Bolts, Nuts & Wood Platform							
Length (ft.)	Code	Windmill Size					
		6/8 FT		10 FT		12 FT	
		Retail	Weight	Retail	Weight	Retail	Weight
21	C	1,851.00	440	2,349.00	485	-	-
27	C	2,301.00	480	2,929.00	595	-	-
33	C	2,764.00	650	3,567.00	690	4,466.00	770
40	C	3,315.00	760	4,190.50	820	5,379.50	945
47	C	4,263.00	910	4,973.50	950	6,409.00	1,120
53	C	4,973.00	-	5,916.00	-	7,598.00	1,430
60	C	5,945.00	-	6,989.00	-	9,251.00	-
67	C	6,989.00	-	8,120.00	-	10,527.00	-
80	C	9,396.00	-	10,991.00	-	-	-

**Metal Platform available for additional \$175.00

**Metal Platform only available in 6/8 FT & 10 FT models



Base Dimensions (4-post Towers)				
Height	A		B	
	Ft.	Inches	Ft.	Inches
21	6	0	8	5-13/16
27	5	6-13/16	7	10-1/2
33	6	10-3/4	9	9
40	8	2-11/16	11	7-1/2
47	9	6-5/8	13	6
53	10	10-9/16	15	4-1/2
60	12	2-1/2	17	3
67	13	6-7/16	19	1-1/2

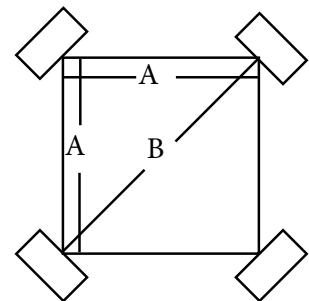

WINDMILL PARTS



Windmill Repair Parts - Model 702

Part No.	Item Description	Code	X 6 ft.	A 8 ft.	B 10 ft.	D 12 ft.
28	Tail Vane Spring	C	17.25	23.13	30.00	48.25
31	Tail Vane with Hardware	C	125.00	160.00	185.00	340.00
34	Outside Wheel Band	C	17.75	21.00	47.00	72.00
35	Inside Wheel Band	C	11.78	15.50	20.00	39.00
44	Narrow U-Bolt	C	6.70	7.70	7.70	8.40
45	Narrow U-Bolt Plate	C	1.50	2.00	2.00	3.00
46	Wide U-Bolt	C	7.41	8.41	8.41	9.41
47	Wide U-Bolt Plate	C	2.02	2.25	2.25	3.12
51	Wood Pump Pole - 14 ft.	C	40.75			
62	Well Rod/Pump Rod Connector Casting	C	22.81	28.50	33.00	
82	Set of Pump Pole Splice Straps	C	22.25	22.25	27.75	34.00
100	Sail with Tie	C	19.50	25.50	47.40	72.00
101	Sail Clip	C	5.25	6.25	10.00	14.75
102	Top Clip for Sail	C	4.00	4.10	8.25	9.75
171	Pump Rod with Casting	C	45.00	48.00	72.50	131.00
243	Steel Furl Handle	C	41.50	43.50	62.00	
334	V-Bolt for Furl Handle	C	6.08	6.08	8.70	11.50
507	Oil Ring	C	3.73	3.83	8.25	9.50
508	Pitman Guide Kit with 565, 588, 508R (2)	C	27.25	40.27	63.25	111.00
508R	Rivets for Pitman Guide	C	1.00	1.00	2.00	2.30
510	Pivot Bolt	C	19.75	24.00	28.00	45.00
517	Spring for Spout Washer	C	2.10	2.15	2.85	4.30
520	Oil Collector	C	7.65	8.80	11.30	13.70
521	Split Steel Washer for Turntable	C	4.75	6.00	6.25	11.00
522	Shaft for Guide Wheel with Pins	C	15.00	15.80	21.20	41.30
523	Guide Wheel	C	26.00	29.52	43.70	73.20
527	Furl Linkage with Pins	C	5.50	8.20	13.00	14.20
528	Button Head Furl Arm with Pins	C	9.20	15.00	18.40	30.50
560	Galvanized Helmet	C	95.00	98.53	125.00	200.00
565	Nut for Pitman Guide Stud	C	7.50	8.51	8.51	9.75
576tk	Thick Steel Washer for Turntable, 10 Gauge	C	1.35	1.65	2.15	3.00
576tn	Thin Steel Washer for Turntable, 14 Gauge	C	1.20	1.60	2.00	2.90
577	Mast Pipe Cup	C	21.85	24.60	31.75	40.00

WINDMILL PARTS

Windmill Replacement Parts - Model 702



Part No.	Item Description	Code	X 6 ft.	A 8 ft.	B 10 ft.	D 12 ft.
578	Locknut for Top of Mast Pipe	C	9.50	11.00	13.75	16.40
579	Washer for Top of Mast Pipe	C	2.60	3.25	4.60	6.00
580	Tail Vane Spring Holder	C	9.55	10.90	13.68	26.45
581	Brake Lever Shaft	C	11.40	16.50	29.90	44.25
585	Tailbone Casting	C	35.00	45.00	54.83	115.00
588	Stud for Hoop	C	6.50	7.11	8.00	13.80
608	Pump Rod Yoke w/ Oil Ring (507) & Pin (610)	C	45.00	52.90	71.30	115.00
609S	Split Furl Lever Complete (4 -post)	C	99.00	125.00	140.00	179.40
610	Pin for Yoke (608)	C	3.80	4.20	7.53	8.33
612	Upper Furl Ring without Arms	C	38.00	49.20	64.11	145.47
613	Upper Furl Ring with Arms (528)	C	50.00	67.25	86.25	177.10
614	Lower Furl Ring without Arms (4-post)	C	34.15	38.75	61.46	86.25
615	Lower Furl Ring without Arms (3-post)	C	52.70	57.20	71.83	91.30
616	Repair Arms for Lower Furl Ring (609) - Pair	C	21.13	24.75	39.10	55.20
622	Pin for Pitman Arm (686)	C	2.30	3.50	4.60	6.90
632	Brake Apparatus Complete	C	77.00	92.12	121.61	190.61
639	Tail Bone	C	74.75	107.68	166.75	247.82
654	Casting for Tail Buffer (659)	C	31.15	37.75	64.57	81.93
655	Casting for Tail Buffer (659)	C	30.15	37.75	67.04	92.34
657	Spring for Tail Buffer (659)	C	7.00	9.25	17.25	32.15
658	Rod for Tail Buffer (659)	C	9.84	13.36	16.78	34.17
659	Tail Buffer Device Complete	C	64.00	71.02	172.73	190.61
661	Mast Pipe Complete (4-post)	C	178.00	205.00	324.47	450.57
662	Mast Pipe Complete (3-Post)	C	188.00	199.45	331.31	457.47
663	Mast Pipe (661) and Furl Lever (670) - 3-post	C	291.90	320.57	423.37	509.39
664	Mast Pipe (661) and Furl Lever (609) - 4-post	C	270.00	320.57	414.00	506.00
670	Furl Lever Complete (3-post)	C	140.00	160.00	140.00	200.73
674	4-post Mast Pipe Base	C	49.67		83.95	115.00
675	3-post Mast Pipe Base	C	66.24		109.25	136.56
676	Mast Pipe w/ Nut (578) & Washer (579), no Base	C	135.00	169.33	267.66	353.68
686	Pitman Arm	C	30.00	45.00	86.25	109.25
690	Brake Band Complete	C	25.00	42.00	50.00	85.67
702	Main Housing (Used)	C	408.90	490.00	845.25	1771.00
M702	Main Housing (New)	C	485.00	536.00	-	-
703	Wheel Hub	C	230.00	276.00	350.75	661.25

WINDMILL PARTS



Windmill Replacement Parts - Model 702

Part No.	Item Description	Code	X 6 ft.	A 8 ft.	B 10 ft.	D 12 ft.
703A	Hub & Shaft Assembly with 729, 744, 745, & 782	C	276.00	330.00	442.75	816.50
704	Pinion Gear	C	42.50	42.09	78.55	120.75
705	Large Gear	C	89.50	115.16	247.88	402.50
708	Babbit Bearing for Pinion Gears	C	36.00	40.00	66.70	108.10
708W	Replacement 708 Holder (Weld in)	C	18.40	26.45	50.70	98.10
711	Nut for Oil Collector (520)	C	3.90	5.00	8.00	14.95
718	Spout Washer	C	6.75	7.15	17.25	21.85
719	Shaft for Hub (703) with 729, 745, & 744	C	49.50	56.00	117.30	172.50
720	Shaft for Large Gears (705) with 721 (2)	C	17.70	24.55	53.24	72.45
721	Pin for Large Gear Shaft (720)	C	2.53	3.00	3.45	5.06
729	Pin for Hub Shaft (719)	C	1.43	1.75	2.01	3.45
730	Sleeve Bearing for Hub Shaft (719)	C	35.05	47.80	97.75	131.10
736	Wheel Arm	C	21.00	28.00	36.80	52.32
737	Repair Clip for Wheel arm (736)	C	5.63	6.61	10.06	12.65
744	Pinion Gear Key	C	2.00	2.00	4.60	8.05
745	Key for Hub (703)	C	2.00	2.00	4.02	5.17
747	Tail Bundle (639, 171, 28, 243, 510)	C	172.50	219.36	326.14	511.63
748	Tail Complete (639, 31)	C	175.00	232.15	339.25	670.45
751	Bearing Bar	C	12.36	11.84	20.70	28.75
752	Babbit Bearing for Large Gears	C	36.74	51.42	87.86	150.36
755	Large Gear Assembly (705 (2), 720, 752, 721 (2))	C	273.12	284.39	573.56	872.85
781	Countersunk Plug for 702 Housing	C	2.50	2.50	4.60	6.32
782	Plug for Hub/Oil Drainage Hole	C	2.50	2.50	4.02	5.17
786	Brake Lever	C	34.17	45.00	57.50	86.25
799	Wheel Section	C	85.95	120.00	196.42	273.12

Windmill Overhaul Kits - Model 702

Part No.	Item Description	Code	X 6 ft.	A 8 ft.	B 10 ft.	D 12 ft.
707	752, 730, 708, 686 (2), 744, 729, 721 (2), 520	C	175.00	225.00	432.00	614.53
770	708, 730, 752, 729, 520, 721 (2)	C	115.00	145.00	260.30	398.13
777	707 Overhaul Kit + 507, 517, 522, 610, 622 (2), 704 (2), 718, 720	C	260.75	345.00	661.25	920.00

WINDMILL PARTS

Windmill Replacement Parts - Model 602



Part No.	Item Description	Code	X 6 ft.	A 8 ft.	B 10 ft.
48	U-Bolt for 503 Hub	C	12.65	14.50	16.25
172	New Pump Rod with Casting - Screw in Yoke (624)	C	55.50	71.95	98.90
503	Wheel Hub	C	170.00	210.00	318.50
503A	Wheel Hub w/ Shaft	C	205.00	287.50	375.00
504	Pinion Gear	C	37.75	50.95	98.75
504P	Pin for 504 Gear	C	3.75	4.15	5.40
506	Long Stroke Single Pin Pitman Arm	C	41.00	51.00	99.75
513	Split Upper Furl Ring without Arms	C	40.25	51.75	69.00
551	Bearing Bar for 552	C	18.00	20.70	27.50
552	Bearing Half	C	17.50	20.15	32.90
553	Large Gear Assembly (554, 555)	C	265.00	305.00	517.00
554	Large Gear with Long Stroke Single Pin (Outer Shaft)	C	135.00	155.00	260.00
555	Large Gear with Long Stroke Single Pin (Inner Shaft)	C	135.00	155.00	260.00
556	Short Stroke Single Pin Pitman Arm	C	38.00	44.00	76.50
557	Large Gear with Short Stroke Single Pin (Outer Shaft)	C	135.00	155.00	260.00
558	Large Gear with Short Stroke Single Pin (Inner Shaft)	C	135.00	155.00	260.00
559	Large Gear Assembly (557, 558)	C	265.00	305.00	517.00
602	Housing (1933 and Older) with New Babbit Bearings	C	345.00	375.00	603.75
604	Large Gear with Adjustable Stroke (Outer Shaft)	C	137.00	155.00	258.75
605	Large Gear with Adjustable Stroke (Inner Shaft)	C	137.00	155.00	258.75
606	Large Gear Assembly (604, 605)	C	272.50	310.50	517.50
618	Spout Washer	C	14.00	14.50	17.25
619	Shaft for 503 Hub	C	65.75	98.70	128.22
624	Screw-in Pump Rod Yoke with Oil Ring	C	40.25	52.65	73.94
636	Wheel Arm for 503 Hub	C	39.50	57.50	88.78
637	Clamp for Inner Band to Wheel Arm	C	7.20	8.40	13.22
652	Bearing to Install 606 Gears into a 702 Housing	C	85.00	99.50	129.37
753	Bearing for Large Gears	C	100.33	126.50	207.00

WINDMILL PARTS



Windmill Assembly Units - Model 602 & 702

702 Gearbox with Helmet				
Part No.	Item Description	Weight (lbs)	Code	Retail
X702MU	6' Muller Gearbox with Helmet	75	C	1,100.00
X702M	6' Rebuilt Aermotor Gearbox with Helmet	75	C	1,060.00
A702MU	8' Muller Gearbox with Helmet	125	C	1,160.00
A702M	8' Rebuilt Aermotor Gearbox with Helmet	125	C	1,160.00
B702M	10' Rebuilt Aermotor Gearbox with Helmet	200	C	1,810.00
D702M	12' Rebuilt Aermotor Gearbox with Helmet	-	C	2,995.00

702 Gearbox less Helmet				
Part No.	Item Description	Weight (lbs)	Code	Retail
X702MULH	6' Muller Gearbox less Helmet	70	C	995.00
X702MLH	6' Rebuilt Aermotor Gearbox less Helmet	70	C	1,035.00
A702MULH	8' Muller Gearbox less Helmet	120	C	1,095.00
A702MLH	8' Rebuilt Aermotor Gearbox less Helmet	120	C	1,095.00
B702MLH	10' Rebuilt Aermotor Gearbox less Helmet	200	C	1,750.00
D702MLH	12' Rebuilt Aermotor Gearbox less Helmet	-	C	2,945.00

602 Gearbox with Helmet				
Part No.	Item Description	Weight (lbs)	Code	Retail
X602M	6' Rebuilt Aermotor Gearbox with Helmet	75	C	1,340.00
A602M	8' Rebuilt Aermotor Gearbox with Helmet	75	C	1,490.00
B602M	10' Rebuilt Aermotor Gearbox with Helmet	125	C	2,195.00

602 Gearbox less Helmet				
Part No.	Item Description	Weight (lbs)	Code	Retail
X602MLH	6' Rebuilt Aermotor Gearbox less Helmet	70	C	1,390.00
A602MLH	8' Rebuilt Aermotor Gearbox less Helmet	120	C	1,440.00
B602MLH	10' Rebuilt Aermotor Gearbox less Helmet	120	C	2,145.00

WINDMILL PARTS

Windmill Assembly Units - Model 602 &702



Complete Wheel				
Part No.	Item Description	Weight (lbs)	Code	Retail
X799C	6' Wheel with Wheel Arms	-	C	690.00
A799C	8' Wheel with Wheel Arms	-	C	950.00
B799C	10' Wheel with Wheel Arms	-	C	1,425.00
D799C	12' Wheel with Wheel Arms	-	C	2,040.00

Wheel Less Wheel Arms				
Part No.	Item Description	Weight (lbs)	Code	Retail
X799LS	6' Wheel less Wheel Arms	-	C	485.00
A799LS	8' Wheel less Wheel Arms	-	C	685.00
B799LS	10' Wheel less Wheel Arms	-	C	1,075.00
D799LS	12' Wheel less Wheel Arms	-	C	1,540.00

Set of Wheel Arms				
Part No.	Item Description	Weight (lbs)	Code	Retail
X736S	6' Set of Wheel Arms	-	C	235.00
A736S	8' Set of Wheel Arms	-	C	310.00
B736S	10' Set of Wheel Arms	-	C	430.00
D736S	12' Set of Wheel Arms	-	C	610.00

WINDMILL PARTS



Windmill Tower Repair Parts

Windmill Tower Parts					
Part No.	Description	Code	6-8 Ft	10 Ft	12 Ft
243	Steel Furl Handle	C	41.50	43.50	62.00
T-1	Wood Platform	C	145.00	175.00	205.00
T-1M	Metal Platform	C	320.00	350.00	-
T-2	Platform Bolt	C	5.75	5.75	5.75
T-3	Stub Tower Clamp	C	10.92	11.50	19.55
T-4	Loup Step	C	16.56	16.56	16.56
T-5	Anchor Post	C	72.18	80.18	83.38
T-6	Top Corner Post (7' Stub)	C	75.10	97.75	126.50
T-7	Top Corner Post (7' Stub for 21' Tower)	C	86.60	109.25	-
T-8	Top Corner Post (7' Stub w/ Loup Ladder)	C	86.60	109.25	126.50
T-9	Top Corner Post (7' Stub for 21' Tower w/ Loup Ladder)	C	92.35	115.00	-
T-10	Top Corner Post (13' 6" Stub)	C	157.72	207.00	258.75
T-11	Top Corner Post (13' 6" Stub with Loup Ladder)	C	201.25	253.00	299.00
T-12	Corner Post (13' 6")	C	132.25	161.00	195.50
T-13	Corner Post (13' 6" w/ Loup Ladder)	C	178.25	207.00	241.50
T-14	Angle Brace Bottom Left (21' Tower)	C	40.25	40.25	-
T-15	Angle Brace Bottom Right (21' Tower)	C	40.25	40.25	-
T-16	Angle Brace Top Left (21' Tower)	C	43.70	43.70	-
T-17	Angle Brace Top Right (21' Tower)	C	43.70	43.70	-
T-18	Angle Brace Bottom Left (27/33/40' Tower)	C	46.00	46.00	60.38
T-19	Angle Brace Bottom Right (27/33/40' Tower)	C	46.00	46.00	60.38
T-20	Angle Brace Top Left (27/33/40' Tower)	C	49.45	49.45	66.12
T-21	Angle Brace Top Right (27/33/40' Tower)	C	46.00	46.00	63.25
T-22	Angle Brace Bottom Left (47/53' Tower)	C	51.20	51.20	64.50
T-23	Angle Brace Bottom Right (47/53' Tower)	C	51.20	21.20	64.50
T-24	Angle Brace Top Left (47/53' Tower)	C	54.00	54.00	70.15
T-25	Angle Brace Top Right (47/53' Tower)	C	21.20	21.20	67.85
T-26	Angle Brace Bottom Left (60/67' Tower)	C	61.50	61.50	71.30
T-27	Angle Brace Bottom Right (60/67' Tower)	C	61.50	61.50	71.30
T-28	Angle Brace Top Left (60/67' Tower)	C	62.10	62.10	80.50
T-29	Angle Brace Top Right (60/67' Tower)	C	64.40	64.40	72.45
T-30	Girt 22" (21' Tower)	C	19.55	19.55	-
T-31	Girt 46" (21' Tower)	C	27.00	27.00	-
T-32	Round Brace - 7 Ft.	C	14.95	14.95	19.55
T-33	Round Brace - 7.5 Ft.	C	21.85	21.85	25.88
T-34	Round Brace - 8 Ft.	C	23.00	23.00	28.75
T-35	Round Brace - 9 Ft.	C	25.87	25.87	30.76
T-36	Round Brace - 10 Ft.	C	27.30	27.30	32.78
T-37	Round Brace 11 Ft.	C	28.75	28.75	33.92
T-38	Girt 16"	C	18.40	18.40	21.00
T-39	Girt 33"	C	24.15	24.15	28.75
T-40	Girt 49"	C	28.75	28.75	36.00
T-41	Girt 65"	C	35.08	35.08	41.40
T-42	Girt 81"	C	44.30	44.30	48.87
T-43	Girt 97"	C	46.58	46.58	54.05
T-44	Girt 113"	C	51.75	51.75	59.80
T-45	Girt 130"	C	57.50	57.50	66.15

WINDMILL PARTS

Windmill Supplies



Windmill Oil - 10 Wt. Non Detergent			
Part No.	Item Description	Code	Retail
OIL1Q	1 Quart	A	3.20
OIL12Q	12 Quarts Case	A	37.37
OIL25G	2.5 Gallon Bucket	A	31.68
OIL5G	5 Gallon Bucket	A	63.36

Babbitt (White Metal)			
Part No.	Item Description	Code	Retail
BAB100	Babbitt (Per Lbs.)	A	11.06
BABCLAY	Molding Clay (Strip)	A	8.00

Wheel Arm Inserts for Hub			
Part No.	Item Description	Code	Retail
INSERT6	6' Hub Insert	B	20.90
INSERT8	8' Hub Insert	B	25.00
INSERT10	10' Hub Insert	B	35.00
INSERT12	12' Hub Insert	B	42.50

Thread Taps			
Part No.	Item Description	Code	Retail
MTAP6	6' Mast Pipe Tap (7/8 - 18)	B	105.00
MTAP8	8' Mast Pipe Tap (1-1/8 - 18)	B	225.00
MTAP10	10' Mast Pipe Tap (1-1/2 - 12)	B	440.00
MTAP12	12' Mast Pipe Tap (1-3/4 - 10)	B	495

Part No.	Item Description	Code	Retail
HTAP6	6' Hub Tap (11/32 - 18 NS)	B	49.00
HTAP8	8' Hub Tap (13/32 - 16 NS)	B	55.00
HTAP10	10' Hub Tap (15/32 - 12 NS)	B	63.00
HTAP12	12' Hub Tap (19/32 - 13 NS)	B	115.00

WELL SUPPLIES



Shallow Well Windmill Pumps

442 Shallow Well Cylinder - Midland Mfg.

Part No.	Cylinder Size	Pipe Connection	Stroke	Code	Retail
613	2 x 16	1-1/4	8	C	206.08
614	2 x 18	1-1/4	10	C	212.08
615	2 x 20	1-1/4	12	C	218.08
618	2-1/4 x 16	1-1/4	8	C	231.06
619	2-1/4 x 18	1-1/4	10	C	237.56
6110	2-1/4 x 20	1-1/4	12	C	244.06
6113	2-1/2 x 16	1-1/4	8	C	249.30
16113	2-1/2 x 16	1-1/2	8	C	249.30
6114	2-1/2 x 18	1-1/4	10	C	256.30
16114	2-1/2 x 18	1-1/2	10	C	256.30
6115	2-1/2 x 20	1-1/4	12	C	263.30
16115	2-1/2 x 20	1-1/2	12	C	263.30
6123	3 x 16	1-1/4	8	C	328.60
16123	3 x 16	1-1/2	8	C	328.60
26123	3 x 16	2	8	C	328.60
6124	3 x 18	1-1/4	10	C	336.20
16124	3 x 18	1-1/2	10	C	336.20
26124	3 x 18	2	10	C	336.20
6125	3 x 20	1-1/4	12	C	344.60
16125	3 x 20	1-1/2	12	C	344.60
26125	3 x 20	2	12	C	344.60
6128	3-1/2 x 16	2	8	C	432.78
6129	3-1/2 x 18	2	10	C	441.78
6130	3-1/2 x 20	2	12	C	450.78
6133	4 x 16	2	8	C	537.86
6134	4 x 18	2	10	C	547.86
6135	4 x 20	2	12	C	557.86

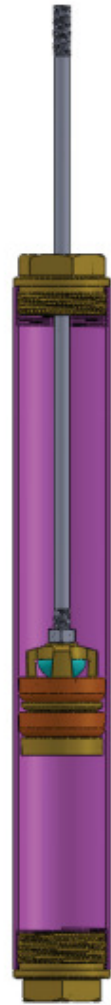

442 Shallow Well Cylinder - Maass Midwest

Part No.	Cylinder Size	Pipe Connection	Stroke	Code	Retail
920830	1-11/16 x 18	1-1/4	8	C	177.25
920860	2 x 18	1-1/4	8	C	214.75
920872	2-1/4 x 18	1-1/4	8	C	244.25
920884	2-1/2 x 18	1-1/4	8	C	273.19
920908	3 x 18	1-1/4	8	C	373.61

WELL SUPPLIES

Deep Well Windmill Pumps



449 Deep Well Cylinder (3 Leather Spool Plunger) - Midland Mfg.

Part No.	Cylinder Size	Pipe Connection	Stroke	Code	Retail
211	1-3/8 x 18	1-1/2	10	C	257.08
212	1-3/8 x 24	1-1/2	17	C	277.08
213	1-3/8 x 30	1-1/2	23	C	297.08
215	1-7/8 x 24	2	14	C	304.38
216	1-7/8 x 30	2	20	C	326.38
217	1-7/8 x 36	2	26	C	348.38
218	1-7/8 x 42	2	32	C	370.38
219	2-1/4 x 24	2-1/2	13	C	377.84
2110	2-1/4 x 30	2-1/2	19	C	409.84
2111	2-1/4 x 36	2-1/2	26	C	441.84
2112	2-1/4 x 42	2-1/2	31	C	473.84
2113	2-3/4 x 24	3	12	C	562.46
2114	2-3/4 x 30	3	18	C	598.46
2115	2-3/4 x 36	3	24	C	634.46
2118	3-3/4 x 36	4	20	C	994.88

449 Deep Well Cylinder (3 Leather Ball Plunger) - Midland Mfg.

Part No.	Cylinder Size	Pipe Connection	Stroke	Code	Retail
231	1-3/8 x 18	1-1/2	10	C	251.50
232	1-3/8 x 24	1-1/2	17	C	271.50
233	1-3/8 x 30	1-1/2	23	C	291.50
235	1-7/8 x 24	2	14	C	308.00
236	1-7/8 x 30	2	20	C	330.00
237	1-7/8 x 36	2	26	C	352.00
238	1-7/8 x 42	2	32	C	374.00
239	2-1/4 x 24	2-1/2	13	C	399.90
2310	2-1/4 x 30	2-1/2	19	C	431.90
2311	2-1/4 x 36	2-1/2	26	C	463.90
2312	2-1/4 x 42	2-1/2	31	C	495.90
2313	2-3/4 x 24	3	12	C	584.58
2314	2-3/4 x 30	3	18	C	620.58
2315	2-3/4 x 36	3	24	C	656.58
2318	3-3/4 x 36	4	20	C	1,152.56



WELL SUPPLIES



Cup Leathers



Cup Leathers - A-1 (94, 94H, & 95)			
Size	Hole Size	Code	Retail (Dozen)
1-5/16	5/8	B	49.57
1-3/8	5/8	B	49.57
1-11/16	5/8	B	49.57
1-3/4	1-1/8	B	49.88
1-13/16	1-3/16	B	49.88
1-7/8	1-1/4	B	49.88
1-15/16	1-5/16	B	63.65
2	1-5/16	B	63.65
2-1/16	1-3/8	B	70.53
2-1/8	1-3/8	B	70.53
2-1/4	1-1/2	B	70.53
2-3/8	1-1/2	B	72.52
2-1/2	1-11/16	B	72.52
2-9/16	1-11/16	B	72.52
2-5/8	1-11/16	B	84.76
2-3/4	1-7/8	B	84.76
2-7/8	2	B	95.93
3	2	B	95.93
3-1/16	2	B	112.15
3-1/8	2	B	112.15
3-1/4	2-1/4	B	112.15
3-1/2	2-1/2	B	121.02
3-3/4	2-5/8	B	151.78
4	2-3/4	B	176.41



Neoprene Cups			
Size	Hole Size	Code	Retail (Dozen)
1-3/8	5/8	B	160.00
1-7/8	1-1/4	B	125.92
2	1-5/16	B	132.04
2-1/4	1-1/2	B	141.68
2-1/2	1-11/16	B	147.34
2-3/4	1-7/8	B	164.63
3	2	B	208.39

WELL SUPPLIES



Check & Foot Valves

Stainless Steel Check Valve - 1000 Series

Part No.	Size	Code	Retail
CVS50	1/2	E	17.50
CVS75	3/4	E	23.00
CVS100	1	E	32.80
CVS125	1-1/4	E	42.50
CVS150	1-1/2	E	59.00
CVS200	2	E	98.00

Brass Check Valve - 650 Series (No Lead)

Part No.	Well Seal ID	Code	Retail
CVANL50	1/2	E	14.00
CVANL75	3/4	E	18.90
CVANL100	1	E	26.30
CVANL125	1-1/4	E	35.60
CVANL150	1-1/2	E </td <td>50.00</td>	50.00
CVANL200	2	E	86.00

Stainless Steel Foot Valve - 1100 Series

Part No.	Size	Code	Retail
FVS50	1/2	E	19.70
FVS75	3/4	E	23.00
FVS100	1	E	32.00
FVS125	1-1/4	E	42.00
FVS150	1-1/2	E	54.00
FVS200	2	E	95.00

Bronze Foot Valve - 860 Series (No Lead)

Part No.	Size	Code	Retail
FVANL50	1/2	E	12.00
FVANL75	3/4	E	14.50
FVANL100	1	E	21.70
FVANL125	1-1/4	E	25.00
FVANL150	1-1/2	E	32.00
FVANL200	2	E	39.00



Complete Float Valve with Poly Float (Chain)

Part No.	Item Description	Code	Retail
SFV100HPC	1" High Pressure Float Valve	C	141.20
SFV125HPC	1-1/4 High Pressure Float Valve	C	146.50
SFV150HPC	1-1/2 High Pressure Float Valve	C	183.70
SFV200HPC	2 High Pressure Float Vavle	C	196.50
SFV300HPC	3 High Pressure Float Valve	C	551.80



Complete Float Valve with Poly Float (Direct)

Part No.	Item Description	Code	Retail
SFV100HPD	1" High Pressure Float Valve	C	132.10
SFV125HPD	1-1/4 High Pressure Float Valve	C	137.50
SFV150HPD	1-1/2 High Pressure Float Valve	C	174.70
SFV200HPD	2 High Pressure Float Vavle	C	197.90
SFV300HPD	3 High Pressure Float Valve	C	553.10



Bare Without Stainless Stem, Bullet, & Pin

Part No.	Item Description	Code	Retail
SFV100HPB	1" High Pressure Float Valve	C	98.66
SFV125HPB	1-1/4 High Pressure Float Valve	C	104.01
SFV150HPB	1-1/2 High Pressure Float Valve	C	141.18
SFV200HPB	2 High Pressure Float Vavle	C	149.37
SFV300HPB	3 High Pressure Float Valve	C	504.63



Regular Stuffing Box			
Part No.	Description	Code	Retail
1014	1-1/4" Stuffing Box w/ 7/16" x 18" SS Rod	C	118.14
2014	1-1/4" Stuffing Box w/ 5/8" x 18" SS Rod	C	118.14
1024	1-1/2" Stuffing Box w/ 7/16" x 18" SS Rod	C	126.96
2024	1-1/2" Stuffing Box w/ 5/8" x 18" SS Rod	C	126.96
1034	2" Stuffing Box w/ 7/16" x 18" SS Rod	C	135.86
2034	2" Stuffing Box w/ 5/8" x 18" SS Rod	C	135.86

Spring Loaded Stuffing Box			
Part No.	Description	Code	Retail
10110	1-1/4" Stuffing Box w/ 7/16" x 18" SS Rod	C	126.90
20110	1-1/4" Stuffing Box w/ 5/8" x 18" SS Rod	C	126.90
10210	1-1/2" Stuffing Box w/ 7/16" x 18" SS Rod	C	133.20
20210	1-1/2" Stuffing Box w/ 5/8" x 18" SS Rod	C	133.20
10310	2" Stuffing Box w/ 7/16" x 18" SS Rod	C	139.40
20310	2" Stuffing Box w/ 5/8" x 18" SS Rod	C	139.40

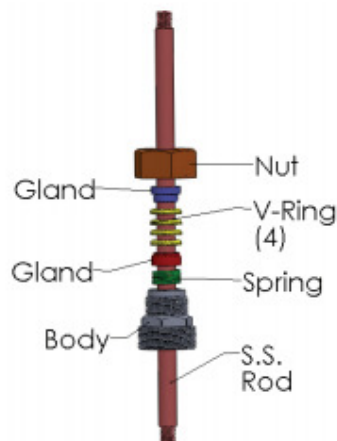

California Windmills

Limited Warranty

California Windmills is proud to offer you this limited warranty which we feel is among the most complete and extensive limited warranty offered by any windmill company. We are able to offer this warranty because of our knowledge of the working conditions of windmills and the quality of the work which has gone into the windmill we offer.

This warranty does not cover damage to controls, pipes and accessories nor labor involved in repairing or replacing this windmill.

Damages due to improper application, abuse or faulty installation are excluded and are not covered by this warranty.

Any Aermotor or Dempster rebuilt windmill or related parts that become inoperative during warranty period, due to defects in material or workmanship will be repaired or replaced at California Windmills option, free of charge to the customer. California Windmills must be notified within 30 days from the date of failure.

Warranty Period

The warranty period for California Windmills rebuilt windmills, including all components, bearings and related parts, is three (3) years

From the date of installation; for the new A 702 Aermotor, it is five (5) years.

Keep the following information for your records, and refer to these details when you contact your dealer for warranty or other service.

MODEL NO. _____

DATE CODE _____

DATE INSTALLED _____

California Windmills

PO BOX 1613

Diamond Springs, CA

(888) 622-8101